

REVISIONS

NO	DESCRIPTION	DATE	BY	APR/DATE
0	ISSUED FOR MANUFACTURE	8/26/11	JS	TP 8/26/11

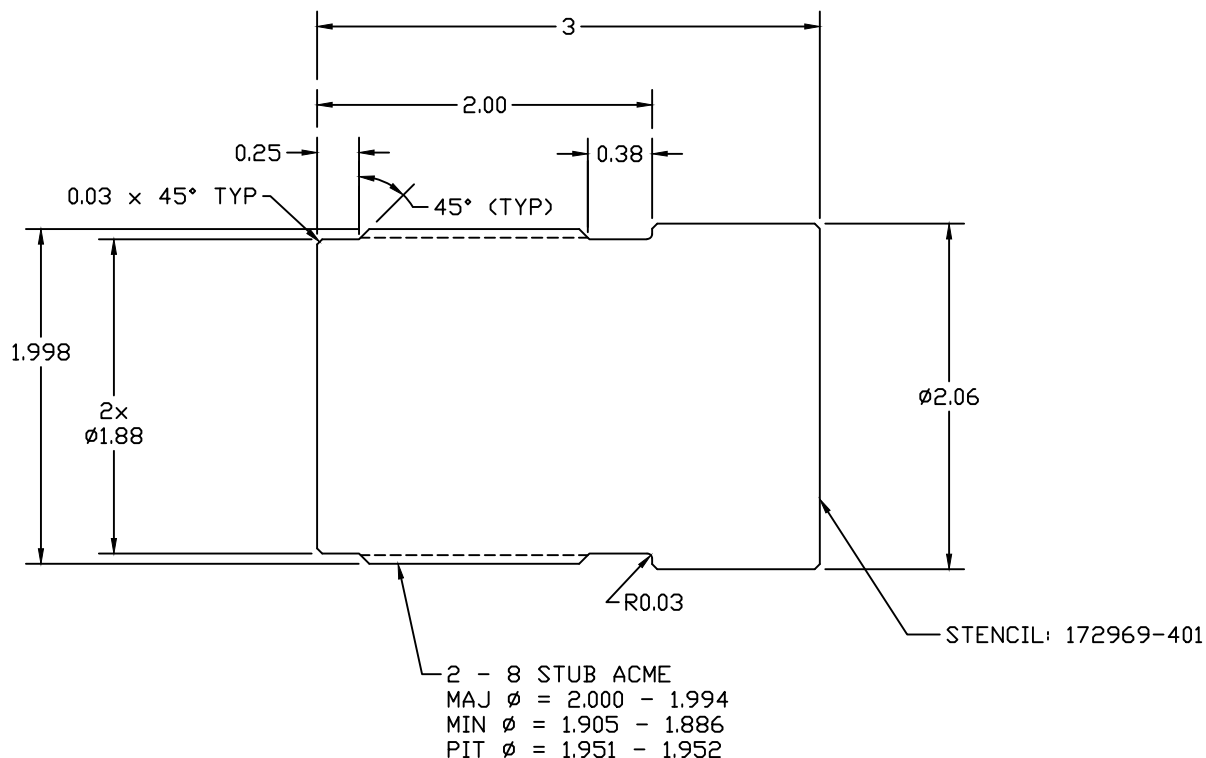

MATERIAL: STEEL
HEAT TREAT:
SURFACE TREAT:

NOTE: MATING PART 172969-311

TOLERANCES:
UNLESS OTHERWISE SPECIFIED

.X ± .030
 .XX ± .010
 .XXX ± .005

ANGLES ± .5°
 BREAK EDGES .015 X 45° MIN

FINISH 125/

0.010 A

ALL DIMS ARE IN INCHES
UNLESS OTHERWISE NOTED.

PROPRIETARY NOTICE

THIS DRAWING AND THE
INFORMATION IT CONTAINS
ARE CONSIDERED
CONFIDENTIAL, AND MAY NOT
BE REPRODUCED, COPIED OR
USED, IN PART OR IN WHOLE,
WITHOUT PRIOR WRITTEN
CONSENT.

SHEET
1 OF 1

SCALE
1:1

BY JS DATE 8/26/11

INTEGRATED OCEAN DRILLING PROGRAM
TEXAS A&M UNIVERSITY
 1000 DISCOVERY DRIVE
 COLLEGE STATION, TX 77845

TITLE
LATCH BOTTOM TEST CAP

SYSTEM
MDHDS

ASSEMBLY

APPROVED
TP

CHECKED
TP

SIZE
A

P/N

172969-401

REV.
0